

ASME B16.34 &  
API 608 Compliant!



### FEATURES

- Seal Welded Construction
- Full Port and Reduced Port Versions Available
- Available in WCB Carbon Steel with 316SS Trim, or CF8M/316 Stainless
- 6000WOG Rating on CF8M, 6170WOG on WCB
- Fully Compliant with ASME B16.34 Class 2500
- PEEK Seats and Viton Seats are Standard
- NPT, MxF NPT and Socket Weld Ends Available
- All Models are NACE MR-01-75 Compliant
- All Models are API 607 Fourth Edition Fire Safe
- Fully Compliant with API 608
- Standard ISO Actuator Mounting Pads on all Sizes
- Standard Locking Stainless Steel Handles
- The Ultimate Valve for Safe Extreme Pressure Service!

### RATINGS

6000 PSIG @ 100F WATER, OIL, GAS (CF8M)  
6170 PSIG @ 100F WATER, OIL, GAS (WCB)  
250 PSIG SATURATED STEAM (PEEK SEATS)

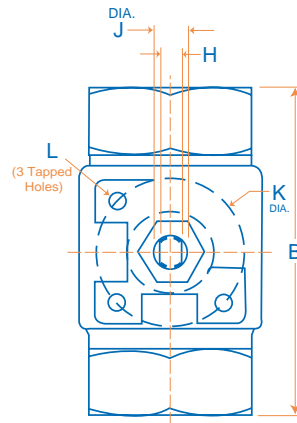
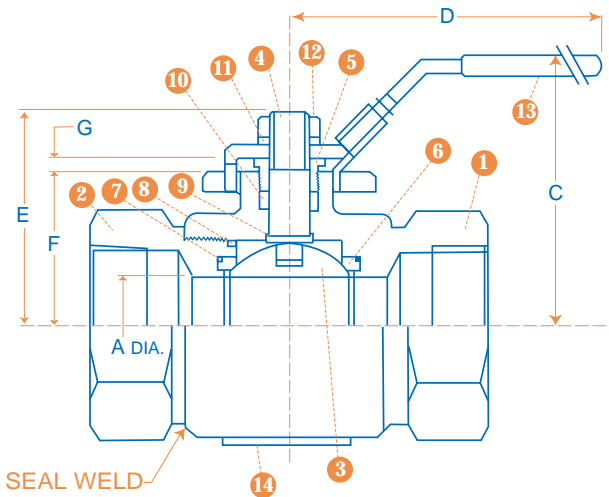

### MATERIALS OF CONSTRUCTION

PART	DESCRIPTION	STANDARD MATERIAL
1	BODY	CF8M OR WCB
2	TAILPIECE	CF8M OR WCB
3	BALL	ASTM A276 GR. 316 SS
4	STEM	17-4PH SS
5	PACKING NUT	ASTM A276 GR. 316 SS
6	SEATS (2)	PEEK
7	SEAT SEAL (2)	VITON
8	TAILPIECE SEAL	GRAPHITE
9	THRUST WASHER	PEEK
10	STEM PACKING	GRAPHITE
11	LOCK WASHER	304 SS
12	HANDLE NUT	304 SS
13	HANDLE ASSY.	304 SS
14	NAME PLATE	300 SS

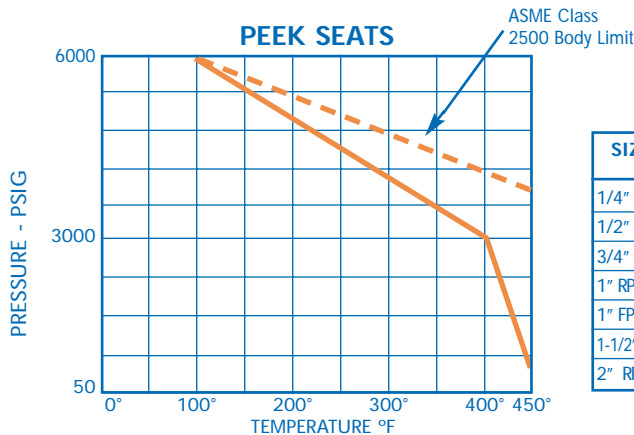

### DIMENSIONS, WEIGHTS, CV FACTORS & MAXIMUM OPERATING TORQUE

SIZE	A	B	C	D	E	F	G	H	J	K DIA.	L (3 TAPPED HOLES)	ISO PATTERN	WEIGHT LBS.	Cv	MAX. TORQUE
1/4" FP	.25	3.0	2.3	5.0	1.62	.89	.33	.20	.31	1.42	1/4"-20 UNC	F03	1.7	10	100 in-lb
1/2" FP	.50	4.0	2.3	5.0	1.62	.89	.33	.20	.31	1.42	1/4"-20 UNC	F03	1.7	16	140 in-lb
3/4" FP	.75	4.3	2.9	5.8	2.21	1.29	.41	.28	.43	1.65	1/4"-20 UNC	F04	3.5	32	270 in-lb
1" RP	.75	4.3	2.9	5.8	2.21	1.29	.41	.28	.43	1.65	1/4"-20 UNC	F04	3.6	44	270 in-lb
1" FP	1.0	4.8	3.5	7.4	2.79	1.65	.43	.35	.56	1.97	1/4"-20 UNC	F05	6.8	62	700 in-lb
1-1/2" FP	1.5	5.3	4.5	14.0	3.87	2.51	.49	.39	.62	2.76	5/16"-18UNC	F07	15.7	140	1200 in-lb
2" RP	1.5	6.3	4.5	14.0	3.87	2.51	.49	.39	.62	2.76	5/16"-18UNC	F07	16.0	120	1200 in-lb



## SERIES S6-SS & CS

NUMBERING SYSTEM ... HOW TO ORDER:

S6 F S S P F SL TT 075

SERIES	PORT SIZE	BODY MATERIAL	BALL/STEM MAT'L	SEAT MAT'L	SEAL MAT'L	HANDLE TYPE	ENDS	SIZE
S6 = SEAL WELDED 6000WOG	R=REDUCED F= FULL	S = STAINLESS (CF8M) C = CARBON (WCB)	S = 316 STAINLESS A = ALLOY 20 H = HASTELLOY	P = PEEK	F = VITON	SL = STAINLESS LATCH LOCK PA = DOUBLE ACTING PNEUMATIC SA = SPRING RETURN PNEUMATIC SR = DEADMAN HANDLE EA = 115VAC ELECTRIC ACTUATED	TT = FNPT MT = MxF NPT WW=SOCKET WELD WT= SOCKET WELDxFNPT	025 = 1/4" 038 = 3/8" 050 = 1/2" 075 = 3/4" 100 = 1" 125 = 1-1/4" 150 = 1-1/2" 200 = 2"

### OTHER QUADRANT PRODUCTS ... to solve your Fluid Control Problems:

<u><a href="#">SERIES 20-NP</a></u>	Forged Brass 400WOG Reduced Port Ball Valves
<u><a href="#">SERIES 20-BP &amp; BS</a></u>	Cast Bronze 600WOG Full & Reduced Port Ball Valves with Brass or 316SS Trim
<u><a href="#">SERIES 20-CC &amp; CS</a></u>	Carbon Steel Bar Stock 2000WOG Reduced Port Ball Valves with Carbon or 316SS Trim
<u><a href="#">SERIES 21</a></u>	Stainless Steel 2-Piece 1000WOG Full Port Ball Valves
<u><a href="#">SERIES S1</a></u>	Seal Welded Stainless Steel 1000WOG Full Port Ball Valves
<u><a href="#">SERIES S2</a></u>	Seal Welded Stainless Steel 2000WOG Reduced Port Ball Valves
<u><a href="#">SERIES SB</a></u>	Seal Welded Stainless Steel 2160WOG Reduced Port Ball Valves
<u><a href="#">SERIES S3</a></u>	Seal Welded Stainless Steel 3600WOG Reduced Port and Full Port Ball Valves
<u><a href="#">SERIES S5</a></u>	Seal Welded Stainless Steel 5000WOG Reduced and Full Port Ball Valves
<u><a href="#">SERIES S6</a></u>	Seal Welded Stainless Steel 6000WOG Reduced Port and Full Port Ball Valves with FNPT, MxF NPT & Socket Weld Ends
<u><a href="#">SERIES M1</a></u>	3-Piece 4-Bolt Maintenance Design Brass 600WOG Full Port Ball Valves with Plated Brass or 316SS Trim
<u><a href="#">SERIES UU</a></u>	3-Piece Double Union High Pressure Full Port Ball Valves in Carbon and Stainless Steel Construction with FNPT or Socket Weld Ends
<u><a href="#">SERIES BFV-D</a></u>	2" - 48" Ductile Iron Butterfly Valves with Ductile, Aluminum Bronze, or CF8M Discs and Buna-N, EPDM or Viton Seats- Lever, Gear Operators or Pneumatic/Electric Actuators
<u><a href="#">SERIES BFV-A</a></u>	2" - 12" A-395 Ductile Iron Butterfly, Split Shaft, all Disc Materials and Buna-N or Viton Seats, NACE Compliant, Lever, Gear Operators or Electric/Pneumatic Actuators